

FILED FOR RECORD: 5-26
DULY RECORDED: 5-31
INSTRUMENT NO. _____

19 83 at 2:30 o'clock P M
19 83 at 9:00 o'clock A M
GRACE BOSTICK TYLER CO. CLK.
BY: Jean Phillips Deputy
JEAN PHILLIPS

TYLER COUNTY COMMISSIONER'S COURT
SPECIAL MEETING
MAY 17, 1983

VOL 008 PAGE 223

A Special Meeting of the Commissioner's Court met on Tuesday, May 17, 1983, at 10:00 A. M. All members being present. The meeting was opened with Prayer by County Judge Allen Sturrock.

A motion was made by Commissioner Lowe and seconded by Commissioner Mahan to approve the County Treasurer's monthly reports for March and April, 1983, as submitted by County Treasurer Austin Fuller. All voted yes and none no. See Attached.

A motion was made by Commissioner Riley and seconded by Commissioner Lowe to approve paying bills, as submitted by County Auditor Ann Nichol. All voted yes and none no. See Attached.

A motion was made by Commissioner Riley and seconded by Commissioner Odom to approve the removing of iron ore gravel from Kirby Property located in Precinct I, to be used in maintenance of county roads in Precinct I. All voted yes and none no. See Attached.

A motion was made by Commissioner Lowe and seconded by Commissioner Odom to approve the County Extension monthly report, as submitted by the County Extension Office. All voted yes and none no.

A motion was made by Commissioner Lowe and seconded by Commissioner Odom to approve the request of Commissioner Lowe to solicit for bids for materials to build a new Billums Creek bridge, located in Precinct II. When sufficient bids are received, an emergency meeting will be called for the purpose of opening the bids. All voted yes and none no.

There being no further business, the meeting adjourned.

SIGNED Allen Sturrock Allen Sturrock, County Judge
Maxie Riley Maxie Riley, Comm. Pct. #1
H. K. Lowe H. K. Lowe, Comm. Pct. #2
Jerry Mahan Jerry Mahan, Comm. Pct. #3
Berton A. Odom Berton A. Odom, Comm. Pct. #4
ATTEST Grace Bostick Grace Bostick, County Clerk

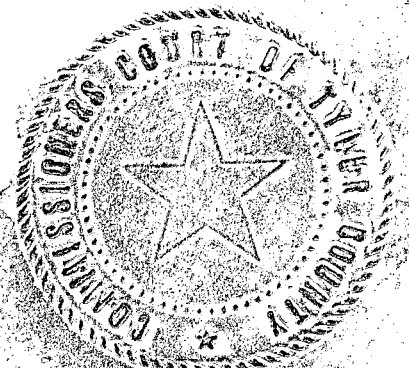

VOL 008 PAGE 224

COUNTY TREASURER'S REPORT
FOR THE PERIOD ENDING

MARCH 1983
COUNTY TREASURER
AUSTIN FULLER

RECEIPTS, DISBURSEMENTS AND CASH BALANCES

All Funds

Austin Fuller

Month Of MARCH 1983

County Treasurer

	FUND	Cash On Hand	Receipts Present Month	Transfers In (Out)	Disbursements Current	Cash On Hand	Certificates of Deposit	Available Resources
	General	18,591.86	330,201.23	2,670.00	439,288.35	(87,825.26)	300,000.00	212,174.74
	Solid Waste	3,864.23	192.30			4,056.53		4,056.53
	Tyler County Auto Report	4,091.45	51,196.83	(30,907.01)	30,315.23	(5,933.96)	29,654.53	23,720.57
	Library	14,022.35	115.00		904.12	13,233.23		13,233.23
	Capital Improvements	95,470.77			1,395.00	94,075.77		94,075.77
	R & B #1	41,958.57	423.40	57,364.32	21,896.58	77,849.71		77,849.71
	R & B #2	61,240.72	384.76	48,480.10	12,449.91	97,655.67		97,655.67
	R & B #3	2,469.72	582.12	67,730.10	19,318.42	51,463.52		51,463.52
	R & B #4	54,950.34	498.69	61,369.94	15,865.64	100,953.33		100,953.33
	County Attorney Check Fees	388.63	150.00		284.25	254.38		254.38
	District Attorney Check Fees	900.87	80.00			980.87		980.87
	General R & B #2		206,707.45	(206,707.45)	200,000.00	(200,000.00)	200,000.00	.00
	Adult Probation	25,080.82	10,965.95		6,362.30	29,684.47		29,684.47
	Juvenil Probation	1,934.61	46.19		2,347.14	(366.34)		(366.34)
	County Wide ROW	49,942.15	2,126.70		97,193.95	(45,125.10)		(45,125.10)
	State Cost #1	7,073.50	1,745.00			8,818.50		8,818.50
	State Cost #2	1,335.40	330.00			1,665.40		1,665.40
	State CVC	116.50	200.00		261.25	55.25		55.25
	Totals For All Funds	383,432.49	605,945.62	.00	847,882.14	141,495.97	529,654.53	671,150.50
	Bank Statement Balance							157,520.24
	Less Outstanding Checks							16,024.27
	Total Cash In Bank							141,495.97
	Correction due to typing error.							

VOL 008 PAGE 225

BALANCES, RECEIPTS AND DISBURSEMENTS

All Funds

Austin Fuller

Month Of MARCH 1983

County Treasurer

FUND	Cash On Hand	DEPOSITS	DRAWN	Cash On Hand	Begin Bank Balance
Tyler County Payroll					177.12
General		117,090.36	59,448.98		
Rev. Share			2,296.15		
Adult Probation			4,259.49		
Juvenile Probation			2,028.00		
County Attorney Check Fees			250.00		
R & B #1			8,213.00		
R & B #2			6,257.00		
R & B #3			10,766.00		
R & B #4			10,241.00		
Matching Funds			13,331.57		
Payroll Totals			117,091.19	176.29	
Bank Statement Balance					46,871.39
Less Outstanding Checks					46,695.10
Total Cash In Bank					176.29
Correction due to typing error					

VOL 008 PAGE 226

BALANCES, RECEIPTS AND DISBURSEMENTS

All Funds

Austin Fuller

Month Of March

County Treasurer

	FUND	Cash On Hand	Receipts Present Month	Transfers In (Cut)	Disbursements Current	Cash On Hand	Certificates of Deposit	
	Indebtedness:							
	R & B #1-Motor Grader		New equipment added to report.					70,826.00
	R & B #1-John Deere Tractor							7,222.75
	R & B #1-Tractor Backhoe							5,000.00
	R & B #2-Motor Grader							15,995.00
	R & B #2-John Deere Tractor							17,269.50
	R & B #3-Mack Truck							43,795.00
	R & B #3-Backhoe			payed ck #17245				14,996.25
	R & B #2-Motor Grader							41,326.50
	R & B #4-Motor Grader							42,390.00
	Total Indebtedness							258,821.00
	Social Security Fund	788.19			27.50	760.69		
	Bank Statement Balance					760.69		
	Less Outstanding Checks							
	Total Cash In Bank					760.69		
	Tyler County Retirement		12,659.96		12,659.96	50.95		
	Bank Statement Balance							
	Less Outstanding Checks							
	Total Cash In Bank					50.95		

VOL 008 PAGE 227

BALANCES, RECEIPTS AND DISBURSEMENTS

All Funds

Austin Fuller

Month Of MARCH 1983

County Treasurer

	FUND	Cash On Hand 3-83	Receipts Present Month	Transfers In (Out)	Disburse- Ments Current	Cash On Hand	Certifi- cates of Deposit	Available Resources
003-420	Federal Revenue Sharing	84,170.69			11,142.18			
	General							
	Solid Waste							
	Certificates of Deposit							
	R & B #1							
	R & B #2							
	R & B #3							
	R & B #4							
	Jail							
	Revenue Sharing Totals	84,170.69			11,142.18			73,028.51
	Bank Statement Balance				73,507.62			
	Less Outstanding Checks				479.11			
	Total Cash In Bank							73,028.51
	<i>Austin Fuller</i>							
	Austin Fuller							
	County Treasurer							

VOL 008 PAGE 228

WITNESS OUR HANDS, officially, this 17 day of May A.D.,
1982.

Allen Sturrock
County Judge

Maxie L. Riley
Commissioner Pct. 1

H. K. Lowe
Commissioner Pct. 2

Jerry Mahan
Commissioner Pct. 3

Berton A. Odom
Commissioner Pct. 4

SWORN TO AND SUBSCRIBED before me, by Allen Sturrock, County Judge, and Maxie L. Riley, Commissioner Pct. 1, Kenneth Lowe, Commissioner Pct. 2, Jerry Mahan, Commissioner Pct. 3, and Berton A. Odom, Commissioner Pct. 4, County Commissioners of Tyler County, Texas, each respectively, on this 17 day of May A.D., 1982.

Grace Bastick
Tyler County Clerk

By _____
Deputy



VOL. 008 PAGE 229

VOL 008 PAGE 230

COUNTY TREASURER'S REPORT

FOR THE PERIOD ENDING

May 5, 1983

COUNTY TREASURER

AUSTIN FULLER

RECEIPTS, DISBURSEMENTS AND CASH BALANCES

BALANCES, RECEIPTS AND DISBURSEMENTS

VOL 008 PAGE 231

All Funds

Month Of April 1983

FUND	Cash On Hand	Receipts Present Month	Transfers In (Out)	Disbursements	Cash On Hand	Certificates of Deposit	Available Resources
General	(87,825.26)	782,471.33	(87,515.24)	1,095,471.77	(488,340.94)	802,231.52	313,890.58
Solid Waste	4,056.53	96.15			4,152.68		4,152.68
Tyler County Auto Report	(5,933.96)	146,778.14	(46,633.57)	122,962.84	(28,752.23)	128,167.70	99,415.47
Library	13,233.23	130.00		23.28	13,339.95		13,339.95
Capital Improvements	94,075.77			527.00	93,548.77		93,548.77
R & B # 1	77,849.71	309.19	40,454.76	23,795.10	94,818.56		94,818.56
R & B # 2	97,655.67	299.75	34,139.71	12,548.94	119,546.19		119,546.19
R & B # 3	51,463.52	339.39	47,695.57	32,695.48	66,803.00		66,803.00
R & B # 4	100,953.33	454.79	43,216.73	18,330.82	126,294.03		126,294.03
County Attorney Check Fees	254.38	330.00		284.25	300.13		300.13
District Attorney Check Fees	980.87	175.00			1,155.87		1,155.87
General R & B # 2	(200,000.00)	321,357.96	(121,357.96)		.00	201,487.68	201,487.68
Adult Probation	29,684.47	6,522.38		5,665.82	30,541.03		30,541.03
Juvenile Probation	(366.34)	4,921.19		2,074.00	2,480.85		2,480.85
County Wide ROW	(45,125.10)		90,000.00	31.50	44,843.40		44,843.40
State Cost #1	8,818.50	2,280.00		5,116.50	5,982.00		5,982.00
State Cost #2	1,665.40	418.00		960.30	1,123.10		1,123.10
State CVC	55.25	265.00		190.00	130.25		130.25
Totals For All Funds	141,495.97	1,267,148.27	.00	1,320,677.60	87,966.64	1,131,886.90	1,219,853.54
Bank Statement Balance							93,666.45
Less Outstanding Checks							5,699.81
Total Cash In Bank							87,966.64

BALANCES, RECEIPTS AND DISBURSEMENTS

All Funds

Month Of April 1983

VOL 008 PAGE 232

FUND	Cash On Hand	DEPOSITS	DRAWN	Cash On Hand	Beginning Bank Balance
Tyler County Payroll		115,119.53			177.09
General			59,615.78		
Rev Share			2,220.00		
Adult Probation			4,550.49		
Juvenile Probation			1,737.00		
County Attorney Check Fee			250.00		
R & B # 1			8,213.00		
R & B # 2			6,075.00		
R & B # 3			9,093.40		
R & B # 4			10,241.00		
Matching Funds			13,123.86		
Payroll Totals				115,119.53	
Bank Statement Balance					48,806.08
Less Outstanding Checks					48,628.99
Total Cash In Bank					177.09

BALANCES, RECEIPTS AND DISBURSEMENTS

All Funds

Month Of April 1983

VOL 008 PAGE 233

DEPARTMENT	Cash on Hand Books		Cash on Hand Bank Balance	Purchases	Payments	Balance
Indebtedness:						
R & B # 1-Mustang Tractor Grader						56,660.80
R & B # 1-John Deere Tractor						5,000.00
R & B # 1-Crawler						7,222.75
R & B # 2-John Deere Crawler						17,269.50
R & B # 3-Backhoe						9,997.50
R & B # 3-Motor Grader						27,551.00
R & B # 3-Mack Truck						32,846.25
R & B # 4-Motor Grader						28,260.00
Total Indebtedness						184,807.80
Social Security Fund	760.69		760.69			
Tyler County Retirement	50.95		50.95			

BALANCES, RECEIPTS AND DISBURSEMENTS

All Funds

Month Of April 1983

VOL 008 PAGE 234

FUND	Cash on Hand 3-1983	Deposit	Disbursement	Cash on Hand 4-1983	Available Resources
Federal Revenue Sharing Acct. # 003-420	73,028.51	42,997.00	72,489.99		
Federal Revenue Sharing Totals				43,535.52	
Bank Statement Balance					43,535.52
Less Outstanding Checks					.00
Total Cash In Bank					43,535.52

Austin Fuller
County Treasurer

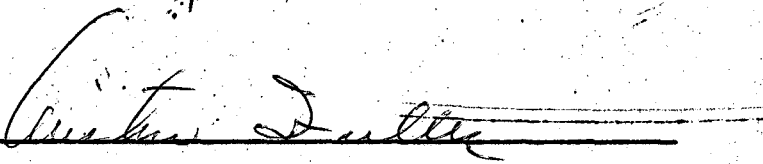

WITNESS OUR HANDS, officially, this 17 day of May A.D., 1982.

[Signature]
County Judge

[Signature]
Commissioner Pct. 1

[Signature]
Commissioner Pct. 2

[Signature]
Commissioner Pct. 3

[Signature]
Commissioner Pct. 4

SWORN TO AND SUBSCRIBED before me, by Allen Sturrock, County Judge, and Maxie L. Riley, Commissioner Pct. 1, Kenneth Lowe, Commissioner Pct. 2, Jerry Mahan, Commissioner Pct. 3, and Berton A. Odom, Commissioner Pct. 4, County Commissioners of Tyler County, Texas, each respectively, on this 17 day of May A.D., 1982.

[Signature]
Tyler County Clerk

By: _____
Deputy

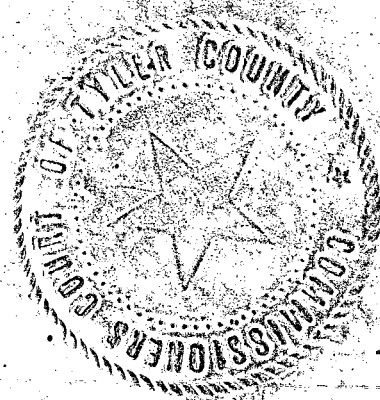

VOL **008** PAGE **236**

Claim Number	NAME OF CLAIMANT	NATURE OF CLAIM	Amount of Claim
	<u>SHERIFF'S DEPARTMENT</u>		
22260	Collier Ins. Agency	Liability & Comp. Ins. on Vehicles	1829.00
22334	Racal-Milgo Info. Systems	Teletype Maint.	147.00
22367	Wal-Mart	Telephone Pick-Up & Tape Film, Cassette Recorder	62.48
22358	The Sign Center, Inc.	Signs (Neighborhood Watch)	51.00
22359	Texaco Inc.	Gas	68.45
22289	Exxon Co.	Gas & Oil	377.37
22298	Gulf Oil Corp	Gas & Oil	80.45
22313	J.E. Gardner Oil co.	Gas	680.41
22322	Mobil Oil Credit Corp.	Gas	18.00
22312	Jackson Petroleum-Gulf	Gas	592.71
22267	A-Z Discount Auto Parts	Parts-71 Datsun	59.59
22360	Tyler Uniform Co. Inc.	Uniforms	1476.91
22274	Big Thicket Communications	Radio Maint & Repairs	248.25
22320	Jarrotts Pharmacy	Film & Photos	55.75
22275	Bob's Prescription Shop	Photographs	24.41
22341	Story-Wright	Office Supplies	23.25
22335	Rogers Office Supply Co.	Office Supplies	24.10
22353	Southwestern Bell	Telephone	446.81
22364	Ty-Co. Feed	Weight Tickets	6.00
			6271.94

APPROVED THIS 17th day of May, 1983

Allen Brantley
COUNTY JUDGE

CLAIMS CHECKED AND APPROVED

Ann Nichol
COUNTY AUDITOR

Claim Number	NAME OF CLAIMANT	NATURE OF CLAIM	Amount of Claim
	<u>COUNTY CLERK</u>		
22353	Southwestern Bell	Telephone	90.79
22335	Rogers Office Supply Co.	Office Supplies	372.88
22387	Xerox Corp.	Copy Machine Useage	276.82
22384	Walraven	Docket Sheets	91.74
22383	Walraven Bros.	Forms	36.01
22327	3M	Paper for Recorder	404.39
22307	Hart-Graphics	Forms	198.41
22286	Collier Ins. Agency	Errors & Omissions Policy	402.91
		<i>TOTAL</i>	<i>1873.99</i>
	<u>ALL OTHER LAW ENFORCEMENT</u>		
22331	Office Supply	Office Supplies-DPS	2.41
22353	Southwestern Bell	Telephone-DPS	127.11
22335	Rogers Office Supply	Office Supplies-Credit Memo	(33.91)
22353	Southwestern Bell	Telephone-P&W	21.61
		<i>TOTAL</i>	<i>117.21</i>
	<u>TREASURER OFFICE</u>		
22333	Pitney-Bowes	Meter Useage & Supplies- ^{Machine} Postage	168.01
22341	Story-Wright	Office Supplies	3.11
		<i>TOTAL</i>	<i>171.61</i>

APPROVED THIS 17th day of May, 1983

Allen Oranoch
COUNTY JUDGE

CLAIMS CHECKED AND APPROVED

Ann Nichol
COUNTY AUDITOR

VOL 008 PAGE 238

Claim Number	NAME OF CLAIMANT	NATURE OF CLAIM	Amount of Claim
	<u>MAINTENANCE OF BUILDING:</u>		
22364	Ty-Co Feed	Lawn Fertilizer	\$ 10.50
22393	Streets Termite & Pest Control	Exterminating Courthouse	75.00
22352	Shepherds Linen Supply	Janitors Uniforms	37.00
22283	Consolidated Marketing, Inc.	RR Supplies & Mops	162.14
22276	Barns Plumbing	Unstop Sewer	28.50
22272	Mrs. A. Begg	See-Spray -Janitors Supplies	57.00
22280	Baxter & Sons Elevator	Repairs to Elevator	529.30
22284	City of Woodville	Courthouse Utilities	1179.72
22355	Sullivans Hardware	Janitors Supplies	36.15
			2,115.31
	<u>COMMUNITY SERVICES:</u>		
22355	Sullivans Hardware	Tools & Supplies for jobs	33.56
			33.56
	<u>HEALTH & WELFARE:</u>		
22292	Fairy Upshaw, Cherokee C.C.	Commitment on L.M. Wilburn (Concerned Citizens)	96.00
22278	Bobs Prescription Shop	Insulin & Syringe for M. Hendrix	7.60
			103.60

APPROVED THIS 17th day of May, 1983

Allen Brantley
COUNTY JUDGE

CLAIMS CHECKED AND APPROVED
Ann Hubel
COUNTY AUDITOR

VOL **008** PAGE **239**

Claim Number	NAME OF CLAIMANT	NATURE OF CLAIM	Amount of Claim
	<u>DIST. CLERK</u>		
22388	Xerox Corp.	Lease Copy Machine	315.00
22335	Rogers Office Supply	Office Supplies	199.40
22353	Southwestern Bell	Telephone	61.58
		<i>TOTAL</i>	<i>575.98</i>
	<u>COUNTY ATTORNEY</u>		
22304	Hartgraphics Inc.	Printed Forms	25.07
22342	West Publishing Co.	Law Books	274.50
22335	Rogers Office Supply	Office Supplies	1.40
22353	Southwestern Bell	Telephone	45.88
		<i>TOTAL</i>	<i>72.35</i>
	<u>DIST. ATTORNEY</u>		
22335	Rogers Office Supply	Office Supplies	52.95
22353	Southwestern Bell	Telephone	103.65
		<i>TOTAL</i>	<i>156.60</i>
	<u>COUNTY EXTENSION</u>		
22335	Rogers Office Supply	Office Supplies	12.25
22353	Southwestern Bell	Telephone	111.10
		<i>TOTAL</i>	<i>123.35</i>
	<u>DIST. JUDGE</u>		
22353	Southwestern Bell	Telephone	42.59
	<u>AIRPORT</u>		
22353	Southwestern Bell	Airport-Telephone	14.83

APPROVED THIS 17th day of May, 1983

Allen D. Brooks
COUNTY JUDGE

CLAIMS CHECKED AND APPROVED

Allen D. Brooks
COUNTY AUDITOR

VOL **008** PAGE **240**

Claim Number	NAME OF CLAIMANT	NATURE OF CLAIM	Amount of Claim
<u>J.P. # I</u>			
22322	Lufkin Typewriter	Supplies	11.00
22335	Rogers Office Supply	Office Supplies	72.58
22353	Southwestern Bell	Telephone	94.48
		Total	178.06
<u>J.P.# II</u>			
22353	Southwestern Bell	Telephone	21.73
22335	Rogers Office Supply	Office Supplies	41.90
		Total	63.63
<u>J.P. # III</u>			
22287	Colmesneil Telephone	Telephone	18.00
22335	Rogers Office Supply	Office Supplies	41.90
		Total	59.90
<u>J.P. # IV</u>			
22335	Rogers Office Supply	Office Supplies	27.10
		Total	27.10
<u>VETERANS SERVICE</u>			
22353	Southwestern Bell	Telephone	26.60
22335	Rogers Office Supply	Office Supplies	3.90
		Total	30.50

APPROVED THIS 17th day of May, 1978

Allen [Signature]
COUNTY JUDGE

CLAIMS CHECKED AND APPROVED
[Signature]
COUNTY AUDITOR

Claim Number	NAME OF CLAIMANT	NATURE OF CLAIM	Amount of Claim
<u>AUDITOR</u>			
22341	Story-Wright	Office Supplies	19.50
22335	Rogers Office Supply	Office Supplies	20.55
22353	Southwestern Bell	Telephone	41.42
		Total	81.47
<u>COUNTY JUDGE</u>			
22382	West Publishing	Annual Chg. for Tex. Law Books	51.00
22353	Southwestern Bell	Telephone	120.52
		Total	171.52
<u>TAX OFFICE</u>			
22369	Western Data Services	Lease & Monthly Rept	1214.15
22305	Hartgraphics	Printed Forms	50.07
22335	Rogers Office Supply	Office Supplies	40.10
22353	Southwestern Bell	Telephone	108.45
		Total	1412.77
<u>FOSTER CHILD CARE</u>			
22386	Mr. & Mrs. Wayne Lee	Mary & Thomas Lorenz & W. Winn	660.00

APPROVED THIS 17th day of May, 1983

Allen [Signature]
COUNTY JUDGE

CLAIMS CHECKED AND APPROVED

[Signature]
COUNTY AUDITOR

VOL **008** PAGE **242**

Claim Number	NAME OF CLAIMANT	NATURE OF CLAIM	Amount of Claim
<u>88TH JUDICIAL DISTRICT:</u>			
22395	James Allison, Atty.	Court Appointed Atty/V. McKettrick	150.00
22397	James A. Clark, Atty.	" " Jesse Powers	150.00
22398	John E. Kinney, Atty.	" " David Laurent	150.00
22399	Jerome Owens, Atty.	" " Gerald P. Lewis	175.00
22321	Kinney & Owens, Attys.	" " Abe Brown	1000.00
22319	James H. Dillion, Atty.	" " Jerry Kirkwood	200.00
222			1825.00
<u>COUNTY COURT:</u>			
22279	Barbara R. Smith, Jasper, Tex.	Court Reporter Travel & Costs/ St. of Tex. vs. Susan Cole Hartman	113.80
			113.80
<u>MISCELLANEOUS:</u>			
22338	Rev. G.L. Butler <i>Void</i>	Mileage to Lufkin re DETCOG	28.00
22326	Monroe Calculator	Service Contract.	75.00
22354	Southwestern Bell Telephone	Probation Telephone	61.53
22247	Deep East Texas Workers Comp.	May Workers Comp.	574.24
22394	Mann Furniture & Appliance Co.	Air Cond for Juv. Prob. Office	429.00
			1167.97
<u>AGEING:</u>			
22353	Southwestern Bell Telephone	Telephone	30.38
22396	Mr. Johnnie Gafford	Mileage re Senior Mayfest	35.00
22385	Woodville Auto Parts	Inspection Sticker	5.00
22285	City of Woodville	Utilities	125.68
22260	Collier Insurance Agency	Liability Ins. on Vehicles	286.00

APPROVED THIS 17th day of May, 1983

Allen Brantley
COUNTY JUDGE

CLAIMS CHECKED AND APPROVED
Allen Nichol
COUNTY AUDITOR

482.00

CLAIM REGISTER AND MINUTES OF ACCOUNTS ALLOWED, Road & Bridge I FUND TYLER COUNTY, TEXA

VOL **008** PAGE **243**

Claim Number	NAME OF CLAIMANT	NATURE OF CLAIM	Amount of Claim
22266	A-Z Discount Auto Parts	Parts	47.94
22366	Woodville Auto Parts	Parts	146.14
22311	Jerry's Exxon Station	Repair to Saw	13.50
22309	Jo-Be Equipment Co.	Parts	68.27
22296	George P. Bane, Inc.	Parts	59.35
22273	Birdwell's Welding & Machine Shop	Welding on Equipment	245.02
22269	Azrock Industries, Inc.	Asphalt	680.42
22349	Southern Pacific Transportation	Rail Service re Asphalt	351.11
22363	Ty-Co Feed	Unloading Pre-Mix.	65.00
22339	Sullivans	Tools & Locks	51.12
22303	Holderman's Bldg. Center	Hand Tools	26.46
22297	Greenwood Exxon Station	Tire Repair	15.00
22314	Jackson Petroleum-Gulf	Fuel & Oil	2,114.72
22288	Davis Food Market	Fuel	20.60
22290	Freemans	Culverts	748.49
22293	Gulf States Utilities	Utilities @ Co. Barn	28.70
22340	Seneca Water Supply Co.	Water @ Co. Barn	8.50
22310	Jim Mahan Plumbing	Repair to Water Line(Spring Valley)	22.02
22247	Seep East Texas Wrokers Comp.	Permium for May	259.26
22260	Collier Insurance Agency	Liability & Comp. Ins.on Vehicles	822.00
		TOTAL	5,793.62
22403	Triangle Equip. Inc.	Soap + Varsol	68.25

APPROVED THIS 17 day of May, 1983

John Hancock
COUNTY JUDGE

CLAIMS CHECKED AND APPROVED

Sam D. ...
COUNTY AUDITOR

CLAIM REGISTER AND MINUTES OF ACCOUNTS ALLOWED, Road & Bridge III FUND TYLER COUNTY, TE

VOL **008** PAGE **245**

Claim Number	NAME OF CLAIMANT	NATURE OF CLAIM	Amount of Claim
22268	Azrock Industries Inc.	Asphalt	680.42
22350	Southern Pacidic Transportation	Rail Services re Asphalt	351.10
22370	Woodville Auto Parts	Parts	7.25
22347	Simmons Garage	Rear end & Labor on '74 Lowboy	675.00
22324	Martins Hardware	Supplies	21.78
22325	Mustang Tractor	Parts	190.78
22317	Jimmy's Auto Parts	Parts	122.48
22271	Allison Chevrolet	Parts	61.60
22392	J.E. Gardner Oil Co.	Fuel	1,764.11
22318	John Walker	Tools	528.00
22282	Colmesniel Telephone Co.	Phone @ Co. Barn	68.25
22306	Hensarling Auto Service	Tire Repair	9.00
22329	Owens Exxon	Tire Repair-74.50, Ice-2.00	76.50
22332	Office Supply Center	Pens & Envelopes	14.66
22247	Deep East Texas Wrokers Comp.	Permium for May	433.20
22260	Collier Ins. Agency	Liability & Comp. Ins on Vehicles	2181.00
22302	Goodyear Auto Service	Tires	153.88
		<i>TOTAL</i>	<i>7,339.01</i>

APPROVED THIS 17 day of May, 1983

Gene Brown
COUNTY JUDGE

CLAIMS CHECKED AND APP
Ann Pibel
COUNTY AUDITOR

CLAIM REGISTER AND MINUTES OF ACCOUNTS ALLOWED, Road & Bridge IV

FUND TYLER COUNTY, TEX

VOL 008 PAGE 246

Claim Number	NAME OF CLAIMANT	NATURE OF CLAIM	Amount of Claim
22368	Woodville Auto Parts	Parts	963.01
22315	Jerry's Exxon Station	Saw Repairs	67.49
22301	Gulf Welding Supply Co.	Welding Supplies	14.40
22343	S & D Salvage (Samuel Bell)	2 Tanks for Culverts	200.00
22291	Freemens	Culverts	89.40
22316	J.E. Gardner Oil Co.	Fuel	1310.40
22299	Gulf Oil Crop.	Gas	15.00
22300	Goodyear Auto Service Center	Tires	262.36
22323	McInnis Hardware	Ice-15.23, Nails-32.50	47.73
22344	Spurger Mercantile	Misc. Supplies	110.09
22345	Spurger Gulf Station	Ice-.75, Parts-7.40	8.15
22346	Southwestern Bell	Telephone @ Co. Barn	21.06
22361	Triangle Equip. Inc.	High Pressure Washer	2134.50
22247	Deep East Texas Workers Comp.	Premium for May	434.02
22260	Collier Ins. Agency	Liability & Comp. Ins on Vehicles	1011.00
22400	Jasper Creosoting Co.	Creosoted Lumber	721.20

APPROVED THIS 17 day of May, 1983
Allen Hancock
 COUNTY JUDGE

CLAIMS CHECKED AND APPROVED
Allen Hancock
 COUNTY AUDITOR

Claim Number	NAME OF CLAIMANT	NATURE OF CLAIM	Amount of Claim
<u>CAPITAL IMPROVEMENT FUND</u>			
22262	Motorola	4 WalkieTalkies	3376.00
<u>JUVENILE PROBATION</u>			
22354	Southwestern Bell Telephone	Telephone Bill	15.68
22247	Deep East Texas Workers Comp.	Workers Comp.-May	4.52
22336	Rogers Office Supply	Envelopes	1.55
			21.75
<u>ADULT PROBATION</u>			
22354	Southwestern Bell Telephone	Telephone Bill	20.66
22247	Deep East Texas Workers Comp.	Workers Comp. - May	9.46
22337	Rogers Office Supply	Supplies	30.65
22351	Story-Wright	Office Supplies	13.78
<u>FEDERAL REVENUE SHARING</u>			
1647-a	Deep East Texas Workers Comp.	Workers Comp. - May	104.65
<u>TRANSFERS FROM GENERAL</u>			
22250	Road & Bridge I	167 Gals. Gas - Ageing	178.69
<u>LIBRARY FUND</u>			
22342	West Publishing Co.	Law Books	274.50

APPROVED THIS 17 day of May, 1983
Allen Daniels
 COUNTY JUDGE

CLAIMS CHECKED AND APPROVED
Allen Daniels
 COUNTY AUDITOR

Kirby Forest

April 28, 1983

Honorable Judge Allen Sturrock
County Judge, Tyler County
Woodville, TX. 75979

VOL 008 PAGE 248

Dear Judge Sturrock:

We have received a request from Commissioner Maxie Riley of Precinct 1 for permission to remove iron ore gravel from Kirby property in the J. W. Richey Survey, Abstract 996, Tyler County, at the location pointed out to our representative approximately as shown on the attached sketch in red.

We hereby grant such permission subject to the following understanding:

1. The material removed hereunder will be used in maintenance of county roads within Precinct 1.
2. Removal will be confined to an area of approximately .07 acre and total quantities removed will not exceed 222 cubic yards.
3. Timber within the pit site will be disposed of by Kirby Forest Industries, Inc.
4. Topsoil on the pit site will be stockpiled, and upon completion of removal the pit will be scarified and the topsoil spread over the pit area and the site left in condition that it will drain freely and will not hold water.
5. Removal will be completed on or prior to December 1, 1983, at which time we would appreciate receiving from you a statement as to quantities actually removed.
6. The material being donated in this instance has an approximate value of \$777.00.
7. In planning, maintaining, operating, or abandoning the pit, we will look to you to comply with all applicable provisions of law and governmental regulations.

You may enter and commence removals subject to the above conditions and your agreement to submit this letter to the next regular session of the Commissioners Court for its official acceptance and approval. If this correctly sets forth our understanding, please execute the duplicate copy of this letter and return to me.

Yours very truly,

Marvin Davenport
Manager - Lands & Forests

Accepted and Approved this 17 day of May, 1983.

Judge Allen Sturrock

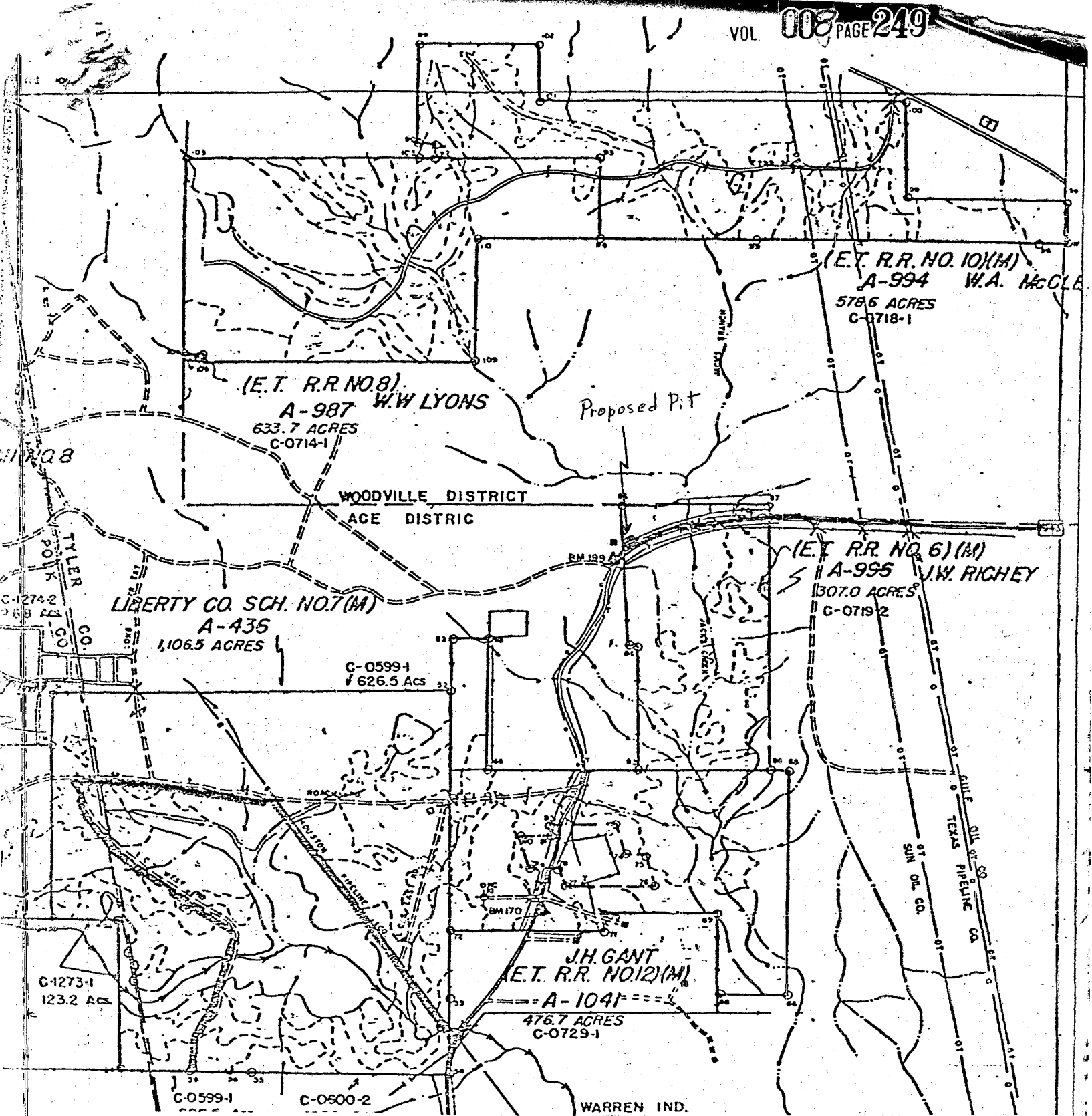

Attached to Letter Agreement dated April 28, 1983, between Kirby Forest Industries, Inc. and the County of Tyler, Texas, depicting the approximate location of proposed pit on Kirby's holdings as shown below.

